



BALD EAGLE Barns, LLC



Old-Fashioned
Quality

Hometown
Service

Unbeatable
Value



Premium Storage Buildings

FOR YOUR OWN BACKYARD

www.baldeaglebarns.com

WELCOME TO BALD EAGLE BARNS!

What is it That Sets Us Apart?



TABLE OF CONTENTS

What Sets Us Apart?	2	Side Lofted Barn Cabin	18-19
Rent to Own Plan	3	Side Cabin	20
Building Style Overview	4-5	Cabin	21
High Barn	6-7	Garage	22-23
Side Lofted Barn	8-9	Barn Garage	24-25
Regular Barn	10	Quality Construction Features	26-27
Quaker	11	Quality Exterior Features	28-29
Workshop	12-13	Options & Upgrades	30-31
Value Shed	14-15	Free Delivery & Setup	32
Barn Cabin	16-17		

OUR COMMITMENT to Quality, Service, and Value

Bald Eagle Barns, LLC, is a family-run company committed to bringing you the *best value* available in portable storage buildings. We don't settle for less, and neither should you! At Bald Eagle Barns you get an impressive blend of quality products at affordable prices, with caring customer service. We strive to treat every customer like we want to be treated. Your needs are important to us! Stop by today to see how a Bald Eagle building can work for you! *Don't settle for less!*

Thank you for choosing Bald Eagle Barns!

Old-Fashioned Quality | Hometown Service | Unbeatable Value

www.baldeaglebarns.com



We guarantee our buildings to be mouse proof when delivered.
(Garages and Value Sheds not guaranteed mouse proof)

Bald Eagle Barns
P.O. Box 57
Cave City AR 72521



Seven year workmanship warranty covers labor and materials on wood buildings. One year workmanship warranty covers labor and materials on value sheds. Warranty excludes storm damage and acts of God.

RENT IT FOR
A SHORT TIME...



...Own it for
a Lifetime!

The Rent to Own Plan allows you to easily get your own building—in your own backyard—for a small monthly payment. You can own your building within 36 or 48 months! You can pay off early anytime with no penalty. If at any time throughout the rental term the building becomes a financial burden to you, just call us and we will pick up the building, and your credit will remain unaffected.

NO CREDIT CHECK! (Security Deposits Required)

- 8' and 10' wide buildings \$100
- 12' wide buildings \$200
- 14' wide buildings \$400



HIGH BARN

With its unique overhead loft design for extra storage, the High Barn gives you the most storage space per dollar spent.

(p. 6)



SIDE LOFTED BARN

With its side entrance and two windows plus overhead loft space, the Side Lofted Barn is very space-efficient and highly attractive!

(p. 8)



REGULAR BARN

For those with moderate storage needs, the Regular Barn is a great starter building.

(p. 10)



QUAKER

The Quaker's classy design and unique roof overhang is patterned after an old-fashioned Pennsylvania Dutch style. Includes two windows with shutters and flower boxes.

(p. 11)



WORKSHOP

The workshop is a very economical, practical, and popular style! The 7'4" wall height offers plenty of head-room and lots of space for shelving.

(p. 12)



VALUE SHED

The Value Shed is designed and built to save you money! This is our economy building, giving you more space for less cost by using a lighter duty frame and 40-year metal siding.

(p. 14)



BUILDING STYLES

An Overview of Our Buildings

(Some buildings shown with optional upgrades.)



BARN CABIN

The Barn Cabin's attractive design features a 4' porch, with overhead lofts inside, including a uniquely designed loft over the front porch.

(p. 16)



SIDE LOFTED BARN CABIN

The Side Lofted Barn Cabin is the most popular style we sell for dwellings. Finish the inside for a family retreat cabin or a full-time residence!

(p. 18)



CABIN

The Cabin is designed much like the workshop. Its distinguishing features are the 4' treated porch, and 8' wall height. Ideal as a backyard guest house, portable office, or a weekend lake cabin!

(p. 21)



SIDE CABIN

The Side Cabin is designed much like the Side Lofted Barn Cabin, but with a gable roof style.

(p. 20)



GARAGE

With its heavy duty floor system and large locking roll-up door, the Garage offers an affordable, portable shelter for your vehicle, ATV, mower, or boat. It's also great if you need a larger shop!

(p. 22)



BARN GARAGE

With a barn roof style, our Barn Garage is king of garages. The higher roof provides extra head-room, plus you get overhead loft space.

(p. 24)



Old-Fashioned
Quality

Hometown
Service

Unbeatable
Value



HIGH BARN

12 x 24 High Barn

Color Scheme	
Siding	Clay
Trim	White
Roof	Burnished Slate



BARN ROOF STYLE
6'4" WALL HEIGHT



7 YEAR WARRANTY

SIZE	PRICE	36 Mo	48 Mo	Security Deposit
8x12	\$2,495	\$115.51	\$98.23	\$100
8x14	\$3,050	\$141.20	\$120.08	\$100
8x16	\$3,100	\$143.52	\$122.05	\$100
10x10	\$2,950	\$136.57	\$116.14	\$100
10x12	\$2,995	\$138.66	\$117.91	\$100
10x14	\$3,450	\$159.72	\$135.83	\$100
10x16	\$3,495	\$161.81	\$137.60	\$100
10x20	\$4,195	\$194.21	\$165.16	\$100
12x12	\$3,595	\$166.44	\$141.54	\$200
12x16	\$4,150	\$192.13	\$163.39	\$200
12x20	\$4,895	\$226.62	\$192.72	\$200
12x24	\$5,750	\$266.20	\$226.38	\$200
12x28	\$6,425	\$297.45	\$252.95	\$200
12x32	\$7,195	\$333.10	\$283.27	\$200
12x36	\$7,995	\$370.14	\$314.76	\$200
14x20	\$6,595	\$305.32	\$259.65	\$400
14x24	\$7,195	\$333.10	\$283.27	\$400
14x28	\$7,895	\$365.51	\$310.83	\$400
14x32	\$8,795	\$407.18	\$346.26	\$400
14x36	\$9,795	\$453.47	\$385.63	\$400
14x40	\$10,750	\$497.69	\$423.23	\$400

Do you know the frustration of not being able to find what you are looking for? You know it's in there, you just don't know where! A High Barn can help solve your problems! Featuring a double loft in most models, this building gives you maximum storage space for your valuables. Now you will have a place for all those closet items, small boxes, totes, seasonal decorations, etc... By keeping your valuables off the floor space and out of your way, yet easily accessible; you will be able to find what you are looking for instead of purchasing another one. This saves you time and money.

Go ahead, try it out, fill em' up! Our lofts are built tough and designed to last for many years. Get more for your money with a High Barn!

Initial rental payment is security deposit plus one payment.

Additional CONFIGURATIONS

Siding	Harvest Red
Trim	White
Roof	Polar White



12 x 16 High Barn

Siding	TinSmith
Trim	Harvest Red
Roof	Rustic Red



8 x 12 High Barn

Siding	Beige
Trim	Brown
Roof	Burnished Slate



14 x 24 High Barn with upgrades (7'4" wall height and window)



Loft Area

Unique FEATURES

High Barns feature a barn roof style, and include overhead lofts in the following sizes:

- Up to 12' long—one 4' loft
- 14' to 24' long—two 4' lofts
- 28' to 40' long—two 8' lofts

Also included: 6' 4" wall height and 5' insulated entry door (4' door on 8' wide sheds).

Popular UPGRADES

See page 30 for a complete listing



Windows \$85 ea.



Ramp \$140-\$160



7' 4" wall height \$200



Shelf Package \$175



Shelves & Workbenches \$5.50 sq. ft.

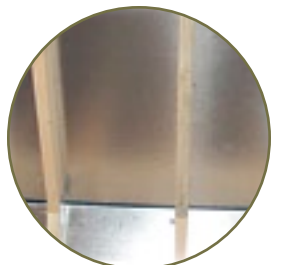

Radiant Barrier Roof: \$.75 sq. ft. Walls: \$1.50 sq. ft.

12 & 14 foot wide High Barns are measured eave to eave; footprint will be narrower.



SIDE LOFTED BARN

10 x 20 Side Lofted Barn Shown with the following upgrades:
6' double door with 9 lites, flower boxes, shutters, and ramp.

Color Scheme	
Siding	Beige
Trim	White
Shutters Flwr Box	Harvest Red
Roof	Burnished Slate



The Side Lofted Barn is designed much like the High Barn, but features a side entrance and includes 2 windows. It also comes standard with overhead loft space. This combination makes the Side Lofted Barn one of our most attractive styles, and a very space-efficient style. This building will enhance your backyard with its good looks!

Initial rental payment is security deposit plus one payment.

Siding	Wedgewood Blue
Trim	White
Roof	Polar White

10 x 20
Side Lofted
Barn



SIZE	PRICE	36 Mo	48 Mo	Security Deposit
8x12	\$2,665	\$123.38	\$104.92	\$100
8x14	\$3,220	\$149.07	\$126.77	\$100
8x16	\$3,270	\$151.39	\$128.74	\$100
10x10	\$3,120	\$144.44	\$122.83	\$100
10x12	\$3,165	\$146.53	\$124.61	\$100
10x14	\$3,620	\$167.59	\$142.52	\$100
10x16	\$3,665	\$169.68	\$144.29	\$100
10x20	\$4,365	\$202.08	\$171.85	\$100
12x12	\$3,765	\$174.31	\$148.23	\$200
12x16	\$4,320	\$200.00	\$170.08	\$200
12x20	\$5,065	\$234.49	\$199.41	\$200
12x24	\$5,920	\$274.07	\$233.07	\$200
12x28	\$6,595	\$305.32	\$259.65	\$200
12x32	\$7,365	\$340.97	\$289.96	\$200
12x36	\$8,165	\$378.01	\$321.46	\$200
14x20	\$6,765	\$313.19	\$266.34	\$400
14x24	\$7,365	\$340.97	\$289.96	\$400
14x28	\$8,065	\$373.38	\$317.52	\$400
14x32	\$8,965	\$415.05	\$352.95	\$400
14x36	\$9,965	\$461.34	\$392.32	\$400
14x40	\$10,920	\$505.56	\$429.92	\$400

Prices do not include sales tax.

Additional CONFIGURATIONS

Siding	White
Trim	Hunter Green
Roof	Ivy Green



10 x 20 Side Lofted Barn with upgrades (shutters and 6' double door with 9 lites)

Siding	Beige
Trim	Harvest Red
Roof	Rustic Red



12 x 16 Side Lofted Barn with upgrades (7'4" wall height, flower boxes, shutters, and ramp)

Siding	Harvest Red
Trim	White
Roof	Polar White



10 x 16 Side Lofted Barn

12 & 14 foot wide Side Lofted Barns are measured eave to eave; footprint will be narrower.



Interior & Loft Area

Unique FEATURES

Side Lofted Barns feature a barn roof style, and include overhead lofts in the following sizes:

- Up to 12' long—one 4' loft
- 14' to 24' long—two 4' lofts
- 28' to 40' long—two 8' lofts

Also included: 6' 4" wall height, 2 large (2 x 3) windows, and 5' insulated side entry door (4' door on 8' wide sheds).

Popular UPGRADES

See page 30 for a complete listing



7' 4" wall height \$200



Ramp \$140-\$160



Shutters \$50 per window
Flower Boxes \$40 per window



Double 9-lite Door Upgrade \$250



Shelves & Workbenches
\$5.50 sq. ft.

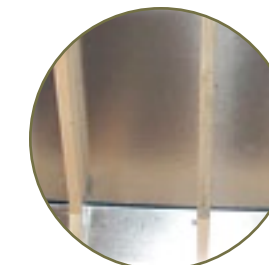

Radiant Barrier
Roof: \$.75 sq. ft.
Walls: \$1.50 sq. ft.



Old-Fashioned
Quality

Hometown
Service

Unbeatable
Value

REGULAR BARN

Color Scheme	
Siding	Harvest Red
Trim	White
Roof	Polar White

8 x 12
Regular Barn



The Regular Barn is for those with moderate storage needs. The old-fashioned barn style looks very attractive in any backyard. With approximately 7' of head room in the center, this little barn is a great starter building!

Popular UPGRADES

See page 30 for a complete listing

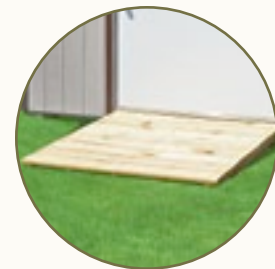

Ramp \$140-\$150



Radiant Barrier
Roof: \$.75 sq. ft. • Walls: \$1.50 sq. ft.

SIZE	PRICE	36 Mo	48 Mo	Security Deposit
8x12	\$2,150	\$99.54	\$84.65	\$100
10x12	\$2,695	\$124.77	\$106.10	\$100

Prices do not include sales tax.
Initial rental payment is security deposit plus one payment.

Unique FEATURES

Regular Barns feature a barn roof style, and include 4' wall height and 5' insulated entry door (4' door on 8' wide sheds).



QUAKER

Color Scheme	
Siding	Clay
Trim	White
Shutters Flwr Box	Hunter Green
Roof	Ivy Green

8 x 16
Quaker



SIZE	PRICE	36 Mo	48 Mo	Security Deposit
8x12	\$2,600	\$120.37	\$102.36	\$100
8x16	\$2,995	\$138.66	\$117.91	\$100
10x12	\$3,125	\$144.68	\$123.03	\$100
10x16	\$3,795	\$175.69	\$149.41	\$100
10x20	\$4,375	\$202.55	\$172.24	\$100

Prices do not include sales tax.

Unique FEATURES

Quakers feature an offset roof style, and include 2 large (2 x 3) windows, shutters, flower boxes, and 5' insulated side entry door (4' door on 8' wide sheds).



Siding	Beige
Trim	White
Shutters Flwr Box	Brown
Roof	Burnished Slate

8 x 16
Quaker



The Quaker's unique and classy design is patterned after an old-fashioned Pennsylvania Dutch style. The attractive roof overhang helps protect the door from the elements. Great for a garden shed, workshop, garage sale booth, guest house, or even a child's playhouse!

WORKSHOP

10 x 16 Workshop

Color Scheme	
Siding	White
Trim	Hunter Green
Roof	Ivy Green



GABLE ROOF STYLE
7'4" WALL HEIGHT



Looking for a good value for your dollar? The workshop is a very economical, practical, and popular style! The 7'4" wall height offers plenty of headroom and lots of space for shelving. Clean out your garage...

Initial rental payment is security deposit plus one payment.

8 x 16 Workshop (side door) with upgrades (2 windows and 5 foot door).

Siding	Beige
Trim	White
Roof	Burnished Slate



SIZE	PRICE	36 Mo	48 Mo	Security Deposit
8x12	\$2,150	\$99.54	\$84.65	\$100
8x14	\$2,650	\$122.69	\$104.33	\$100
8x16	\$2,695	\$124.77	\$106.10	\$100
10x10	\$2,650	\$122.69	\$104.33	\$100
10x12	\$2,695	\$124.77	\$106.10	\$100
10x14	\$3,050	\$141.20	\$120.08	\$100
10x16	\$3,100	\$143.52	\$122.05	\$100
10x20	\$3,695	\$171.06	\$145.47	\$100
12x12	\$3,195	\$147.92	\$125.79	\$200
12x16	\$3,695	\$171.06	\$145.47	\$200
12x20	\$4,295	\$198.84	\$169.09	\$200
12x24	\$4,895	\$226.62	\$192.72	\$200
12x28	\$5,595	\$259.03	\$220.28	\$200
12x32	\$6,425	\$297.45	\$252.95	\$200
12x36	\$7,195	\$333.10	\$283.27	\$200
14x20	\$5,795	\$268.29	\$228.15	\$400
14x24	\$6,495	\$300.69	\$255.71	\$400
14x28	\$7,250	\$335.65	\$285.43	\$400
14x32	\$8,295	\$384.03	\$326.57	\$400
14x36	\$9,150	\$423.61	\$360.24	\$400
14x40	\$9,995	\$462.73	\$393.50	\$400

Prices do not include sales tax.

Additional CONFIGURATIONS

Siding	Harvest Red
Trim	White
Roof	Polar White



8 x 12 Workshop

Siding	Beige
Trim	Brown
Roof	Burnished Slate



12 x 16 Workshop

Siding	Sandstone
Trim	Brown
Roof	Burnished Slate



14 x 24 Workshop

12 & 14 foot wide Workshops are measured eave to eave; footprint will be narrower.



Interior

Unique FEATURES

Workshops feature a gable roof style, and include 7' 4" wall height and 5' insulated entry door (4' door on 8' wide sheds).

Popular UPGRADES

See page 30 for a complete listing



Windows \$85 ea.



Ramp \$140-\$160



8' Wall Height Upgrade \$200
Inside measurement is 7'10"



Shelf Package \$175



Shelves & Workbenches
\$5.50 sq. ft.

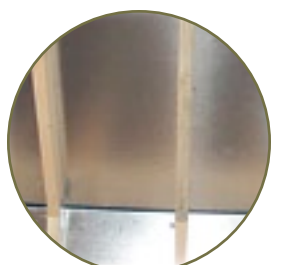

Radiant Barrier
Roof: \$.75 sq. ft.
Walls: \$1.50 sq. ft.



Old-Fashioned
Quality

Hometown
Service

Unbeatable
Value

VALUE SHED

12 x 20 Value Shed
Shown with the following
upgrade: 5' door



SIZE	PRICE	36 Mo	48 Mo	Security Deposit
8x12	\$1,695	\$78.47	\$66.73	\$100
10x12	\$1,995	\$92.36	\$78.54	\$100
10x16	\$2,395	\$110.88	\$94.29	\$100
10x20	\$2,895	\$134.03	\$113.98	\$100
12x16	\$2,895	\$134.03	\$113.98	\$200
12x20	\$3,275	\$151.62	\$128.94	\$200
12x24	\$3,695	\$171.06	\$145.47	\$200

Prices do not include sales tax.
Initial rental payment is security deposit plus one payment.



Interior

Additional CONFIGURATIONS



8 x 12 Value Shed



10 x 16 Value Shed with upgrade (5' Door)



12 x 16 Value Shed

12 foot wide Value Sheds are measured eave to eave; footprint will be narrower.

Standard FEATURES

- Treated 4x4 skids
- Treated 2x6 floor joists 16" on center (2x4 joists on 8' wide sheds)
- 2x6 floor joists secured with 8" screws
- Wall and roof framing 24" on center
- Double gussets on every truss joint
- 5/8" tongue & groove Advantech flooring
- 6' wall height
- 40 year quality 29 gauge metal
- 4' insulated entry door

Standard Colors	
Siding	Light Stone
Roof	Polar White
Trim Color Options	
	Burnished Slate
	Rustic Red
	Polar White
	Ivy Green

Popular UPGRADES



Ramp \$140-\$160



5' Door Upgrade \$50



Light Transmitting Panel \$95

The Value Shed is designed and built to save you money! This is our economy building, giving you more space for less cost by using a lighter duty frame and 40 year metal siding. The Value Shed comes in one standard color with limited options. Side doors and windows are not available. This is a great building for basic storage.

(Value Shed is not guaranteed mouse proof.)

QUALITY STORAGE
for a Great Price!



BARN CABIN

12 x 36 Barn Cabin

Color Scheme	
Siding	Quaker Tan
Trim	Sandstone
Roof	Burnished Slate



Additional CONFIGURATIONS

Siding	White
Trim	Hunter Green
Roof	Ivy Green



12 x 32 Barn Cabin

Siding	Sandstone
Trim	Brown
Roof	Burnished Slate



14 x 40 Barn Cabin

Siding	Sandstone
Trim	Harvest Red
Roof	Rustic Red



12 x 24 Barn Cabin



Interior and Back Loft Area

Unique FEATURES

Barn Cabins feature a barn roof style, and include overhead lofts in the following sizes:

20' to 24' long—two 4' lofts

28' to 40' long—two 8' lofts

Also included: 7' 4" wall height, 3 large (2 x 3) windows, insulated 3' entry door with 9-lite window, and 4' front porch

Popular UPGRADES

See page 30 for a complete listing



Additional Door \$300



Roll Up Door 6 x 7—\$450
8 x 7—\$500 9 x 7—\$550

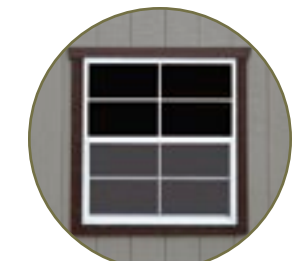

X-LG (3x3) Window
add \$15 ea. upgrade
(Additional 3 x 3 windows \$100 ea.)



Shutters \$50 per window
Flower Boxes \$40 per window

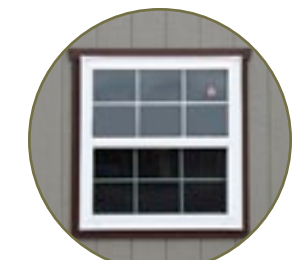

3x3 Insulated Vinyl Windows
add \$110 for each upgrade
(Additional 3x3 vinyl windows \$195 ea.)

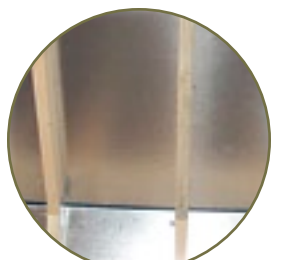

Radiant Barrier
Roof: \$.75 sq. ft.
Walls: \$1.50 sq. ft.

SIZE	PRICE	36 Mo	48 Mo	Security Deposit
10x20	\$4,995	\$231.25	\$196.65	\$100
12x24	\$6,450	\$298.61	\$253.94	\$200
12x28	\$7,195	\$333.10	\$283.27	\$200
12x32	\$8,100	\$375.00	\$318.90	\$200
12x36	\$8,995	\$416.44	\$354.13	\$200
14x24	\$7,995	\$370.14	\$314.76	\$400
14x28	\$8,895	\$411.81	\$350.20	\$400
14x32	\$9,675	\$447.92	\$380.91	\$400
14x36	\$10,595	\$490.51	\$417.13	\$400
14x40	\$11,495	\$532.18	\$452.56	\$400

Prices do not include sales tax.



Interior and Front Loft Area



The Barn Cabin's attractive design features a 4' porch, complete with railings, plus overhead lofts inside, including a uniquely designed loft over the front porch. Great for a weekend getaway retreat, hunting cabin, guest house, or personal office. The Barn Cabin includes 3 windows for lots of light and added ventilation. The overall length includes the 4' porch. (Example: A 12 x 32 Barn Cabin has a 28' room, plus a 4' loft over the porch).

Initial rental payment is security deposit plus one payment.



SIDE LOFTED BARN CABIN

14 x 40 Side Lofted Barn Cabin

Color Scheme	
Siding	Clay
Trim	Brown
Roof	Burnished Slate



SIZE	PRICE	36 Mo	48 Mo	Security Deposit
12x28	\$7,550	\$349.54	\$297.24	\$200
12x32	\$8,575	\$396.99	\$337.60	\$200
14x32	\$10,200	\$472.22	\$401.57	\$400
14x36	\$11,195	\$518.29	\$440.75	\$400
14x40	\$11,995	\$555.32	\$472.24	\$400

Prices do not include sales tax.

This king of our product line is the most popular style we sell for dwellings. You can finish the inside completely for a family retreat cabin or even a full-time residence. With proper insulation, the low energy usage is impressive. The Side Lofted Barn Cabin comes standard with 4 windows for lots of light and added ventilation.

Initial rental payment is security deposit plus one payment.



Interior and 12' Front Loft Area

Additional CONFIGURATIONS

Siding	Harvest Red
Trim	White
Roof	Polar White



12 x 32 Side Lofted Barn Cabin

Siding	Clay
Trim	Brown
Roof	Burnished Slate



14 x 40 Side Lofted Barn Cabin with upgrades (3 x 3 Insulated Vinyl Windows)

Siding	Beige
Trim	Brown
Roof	Burnished Slate



14 x 40 Side Lofted Barn Cabin with upgrades (3 x 3 Insulated Vinyl Windows & Shutters)

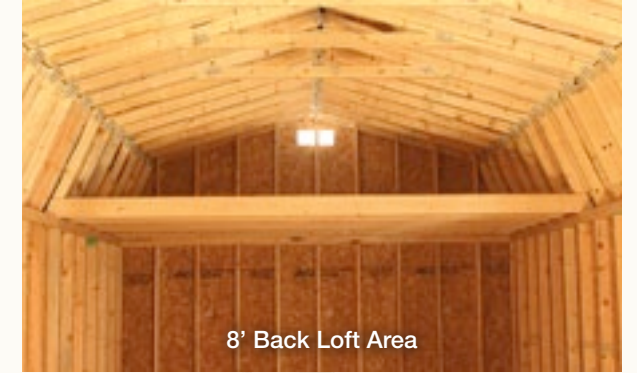

8' Back Loft Area

Unique FEATURES

Side Lofted Barn Cabins feature a barn roof style, and include a 12' overhead loft in the front and an 8' overhead loft in the back.

Also included: 7' 4" wall height, 4 large (2 x 3) windows, insulated 3' entry door with 9-lite window, and 4' x 12' corner porch.

Popular UPGRADES

See page 30 for a complete listing



Additional Door \$300



Roll Up Door 6 x 7—\$450
8 x 7—\$500 9 x 7—\$550



X-LG (3x3) Window
add \$15 ea. upgrade
(Additional 3 x 3 windows \$100 ea.)



Shutters \$50 per window
Flower Boxes \$40 per window

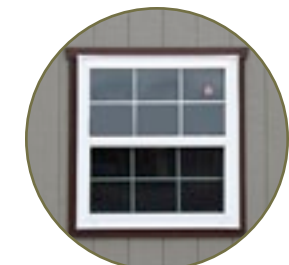

3x3 Insulated Vinyl Windows
add \$110 for each upgrade
(Additional 3x3 vinyl windows \$195 ea.)

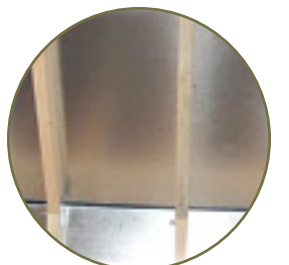

Radiant Barrier
Roof: \$.75 sq. ft.
Walls: \$1.50 sq. ft.

12 & 14 foot wide Side Lofted Barn Cabins are measured eave to eave; footprint will be narrower.



Old-Fashioned
Quality

Hometown
Service

Unbeatable
Value

SIDE CABIN

14 x 40 Side Cabin Shown with the following upgrades:
3 x 3 Insulated Vinyl Windows, one additional window, and radiant barrier roof decking

Color Scheme	
Siding	Quaker Tan
Trim	Sandstone
Roof	Burnished Slate



The Side Cabin is designed much like the Side Lofted Barn Cabin, but with a gable roof style. Also great for use as a cabin, guest house, office, or even a residence. Popular upgrades include larger windows and radiant barrier walls and roof (p. 30).

Unique FEATURES

Side Cabins feature a gable roof style, and include 8' wall height, 4 large (2 x 3) windows, insulated 3' entry door with 9-lite window, and 4 x 12 corner porch.

12 & 14 foot wide Side Cabins are measured eave to eave; footprint will be narrower. 8' wall height is an outside measurement. Interior measurement is 7'10"



14 x 40 Cabin

Color Scheme	
Siding	Sandstone
Trim	Brown
Roof	Burnished Slate



SIZE	PRICE	36 Mo	48 Mo	Security Deposit
8x12	\$3,050	\$141.20	\$120.08	\$100
8x16	\$3,100	\$143.52	\$122.05	\$100
10x20	\$4,595	\$212.73	\$180.91	\$100
12x24	\$5,775	\$267.36	\$227.36	\$200
12x28	\$6,550	\$303.24	\$257.87	\$200
12x32	\$7,195	\$333.10	\$283.27	\$200
12x36	\$7,995	\$370.14	\$314.76	\$200
14x24	\$7,395	\$342.36	\$291.14	\$400
14x28	\$8,195	\$379.40	\$322.64	\$400
14x32	\$8,995	\$416.44	\$354.13	\$400
14x36	\$9,895	\$458.10	\$389.57	\$400
14x40	\$10,795	\$499.77	\$425.00	\$400

Prices do not include sales tax.

Initial rental payment is security deposit plus one payment.

Prices do not include sales tax.



CABIN



Unique FEATURES

Cabins feature a gable roof style, and include 8' wall height, 3 large (2 x 3) windows, insulated 3' entry door with 9-lite window, and 4' front porch.

12 & 14 foot wide Cabins are measured eave to eave; footprint will be narrower. 8' wall height is an outside measurement. Interior measurement is 7'10"

The Cabin is ideal as a backyard guest house, portable office, small home-based business, or a week-end lake cabin!

Color Scheme	
Siding	Quaker Tan
Trim	Sandstone
Roof	Burnished Slate



10 x 20 Cabin

GARAGE

12 x 28 Garage
Shown with the following
upgrade: Heavy duty 8' ramp

Color Scheme	
Siding	Beige
Trim	Hunter Green
Roof	Ivy Green



GABLE
ROOF STYLE
8'
WALL HEIGHT

7
YEAR
Warranty



With its heavy duty floor system and large locking roll-up door, the Garage offers an affordable, portable shelter for your car, truck, ATV, golf cart, large mower, or boat. It's also great if you enjoy woodworking, tinkering, or simply need a larger hobby shop.

(Because of the roll-up door, the Garage is not guaranteed mouse proof.)

Initial rental payment is security deposit plus one payment.

8' wall height is an outside measurement. Interior measurement is 7'10"

SIZE	PRICE	36 Mo	48 Mo	Security Deposit
12x16	\$4,695	\$217.36	\$184.84	\$200
12x20	\$5,195	\$240.51	\$204.53	\$200
12x24	\$5,875	\$271.99	\$231.30	\$200
12x28	\$6,425	\$297.45	\$252.95	\$200
12x32	\$7,150	\$331.02	\$281.50	\$200
12x36	\$7,995	\$370.14	\$314.76	\$200
14x20	\$6,975	\$322.92	\$274.61	\$400
14x24	\$7,595	\$351.62	\$299.02	\$400
14x28	\$8,350	\$386.57	\$328.74	\$400
14x32	\$9,175	\$424.77	\$361.22	\$400
14x36	\$10,250	\$474.54	\$403.54	\$400
14x40	\$11,195	\$518.29	\$440.75	\$400

Prices do not include sales tax.

HEAVY DUTY Floor System

Treated 2x6 floor joists
12" on center
Plus 3/4" Advantech
tongue & groove flooring

Additional CONFIGURATIONS

Siding	Sandstone
Trim	Brown
Roof	Burnished Slate



12 x 24 Garage with upgrade (8' heavy duty ramp)

Siding	Quaker Tan
Trim	Sandstone
Roof	Burnished Slate



12 x 20 Garage

Siding	Clay
Trim	Brown
Roof	Burnished Slate



14 x 40 Garage with upgrade (9 x 7 roll-up door)



Interior

Unique FEATURES

Garages feature a gable roof style, with a heavy duty floor system, and include 8' wall height, large (8 x 7) roll-up door, insulated 3' entry door, and 1 large (2 x 3) window.

Popular UPGRADES

See page 30 for a complete listing



Extra Windows \$85 ea.



9-lite in Door \$75



Ramp \$230-\$240



Shelf Package \$175



Shelves & Workbenches \$5.50 sq. ft.

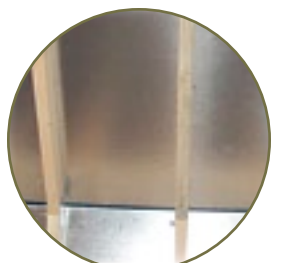

Radiant Barrier Roof: \$.75 sq. ft. Walls: \$1.50 sq. ft.

12 & 14 foot wide Garages are measured eave to eave; footprint will be narrower.



Old-Fashioned Quality

Hometown Service

Unbeatable Value

BARN GARAGE

14 x 28
Barn Garage

Color Scheme	
Siding	Sandstone
Trim	Brown
Roof	Burnished Slate



BARN
ROOF STYLE
7'4" WALL HEIGHT

7
YEAR
Warranty

SIZE	PRICE	36 Mo	48 Mo	Security Deposit
12x16	\$5,250	\$243.06	\$206.69	\$200
12x20	\$5,995	\$277.55	\$236.02	\$200
12x24	\$6,795	\$314.58	\$267.52	\$200
12x28	\$7,350	\$340.28	\$289.37	\$200
12x32	\$7,995	\$370.14	\$314.76	\$200
12x36	\$8,895	\$411.81	\$350.20	\$200
14x20	\$7,800	\$361.11	\$307.09	\$400
14x24	\$8,495	\$393.29	\$334.45	\$400
14x28	\$8,995	\$416.44	\$354.13	\$400
14x32	\$9,975	\$461.81	\$392.72	\$400
14x36	\$10,895	\$504.40	\$428.94	\$400
14x40	\$11,950	\$553.24	\$470.47	\$400

Prices do not include sales tax.

HEAVY DUTY Floor System

Treated 2x6 floor joists
12" on center
Plus 3/4" Advantech
tongue & groove flooring

Additional CONFIGURATIONS



Siding	Harvest Red
Trim	White
Roof	Polar White

14 x 28 Barn Garage



Siding	Beige
Trim	Hunter Green
Roof	Ivy Green

12 x 24 Barn Garage with upgrades (5' wide entry door and 3x3 window upgrade)



Siding	Tinsmith
Trim	Harvest Red
Roof	Rustic Red

12 x 24 Barn Garage with upgrades (8' heavy duty ramp, 9-lite window in entry door and 3x3 window upgrade)



Interior

Unique FEATURES

Barn Garages feature a barn roof style, with a heavy duty floor system, and include overhead lofts in the following sizes:

- 16' to 24' long—two 4' lofts
- 28' to 40' long—two 8' lofts

Also included: 7'4" wall height, large (8 x 7) roll-up door, insulated 3' entry door, & 1 large (2 x 3) window.

Popular UPGRADES

See page 30 for a complete listing



Extra Windows \$85 ea.



5' Wide Entry Door Upgrade \$75



Ramp \$230-\$240



9-lite in Door \$75



X-LG (3x3) Window add \$15 ea. upgrade (Additional 3 x 3 windows \$100 ea.)

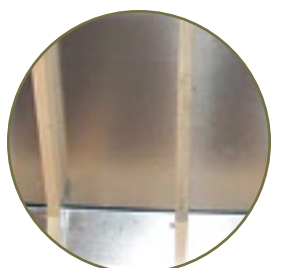

Radiant Barrier Roof: \$.75 sq. ft. Walls: \$1.50 sq. ft.

12 & 14 foot wide Barn Garages are measured eave to eave; footprint will be narrower.



Old-Fashioned
Quality

Hometown
Service

Unbeatable
Value



Hometown Service | Unbeatable Value

What Makes Bald Eagle Barns So Special?

CHECK OUT THESE QUALITY CONSTRUCTION FEATURES

Tongue and Groove Advantech Flooring

Treated 2x6 Floor Joists* 16" on Center

2x6 Floor Joists Securely Screwed With 8" Screws

5 Treated 4x4 Skids**

FLOOR

*Treated 2x4 floor joists in 8' wide models
** 3 Treated skids in 8' wide models

Double Top Plate

2 1/2" x 4" Double Gusset On Every Truss Joint

Wall & Roof Framing Spaced 16" on Center

WALLS & ROOF

Features do not apply to Value Shed Series

From the floor to the roof, these are a few of the construction features that make Bald Eagle Barns a truly first-class product! Stop in today and see for yourself. Don't settle for less!





Quality You Can See

INSIDE AND OUT



40-Year Metal Roof

Built-In Ventilation

50-Year Treated LP Smart Side

Double-Seal Door Frame and Insulated Fiberglass Door with Chain and Locking Knob

Caulking of all Exposed Nail Heads

Two Coats of High Quality 15 Year Paint (Sherwin Williams)

Mouse Proof Mouse Proof does not apply to Value Sheds or Garages

EXTERIOR

BALD EAGLE BARNS is Proud to Use



EXTREME PROTECTION IN TOUGH CLIMATES

Exterior trim and siding are often subjected to extreme temperatures, moisture and insects. That's why Bald Eagle Barns uses LP® SmartSide® products featuring an exclusive SmartGuard process. Only SmartGuard offers four components of protection against termites and fungal decay.



ENGINEERED TOUGHNESS

To Resist Harsh Climates

THE POWER OF SOUND ENGINEERING & SMART PRODUCT DESIGN

Tested in One of the Toughest Places on Earth

LP SmartSide® products have been subjected to the intense moisture and thriving termite colonies of Hilo, Hawaii since 1996. Even after years of exposure, LP SmartSide products remain structurally sound.

LP SMART FACT:
Zinc borate is safely used in household items including paper, carpet and paint.

Treated to the Core

Every LP SmartSide product is treated to the core with an advanced formula of binders, waxes and zinc borate before being bonded with a water-resistant, resin-saturated overlay. This process helps keep out moisture for long-term durability and strength against harsh weather.

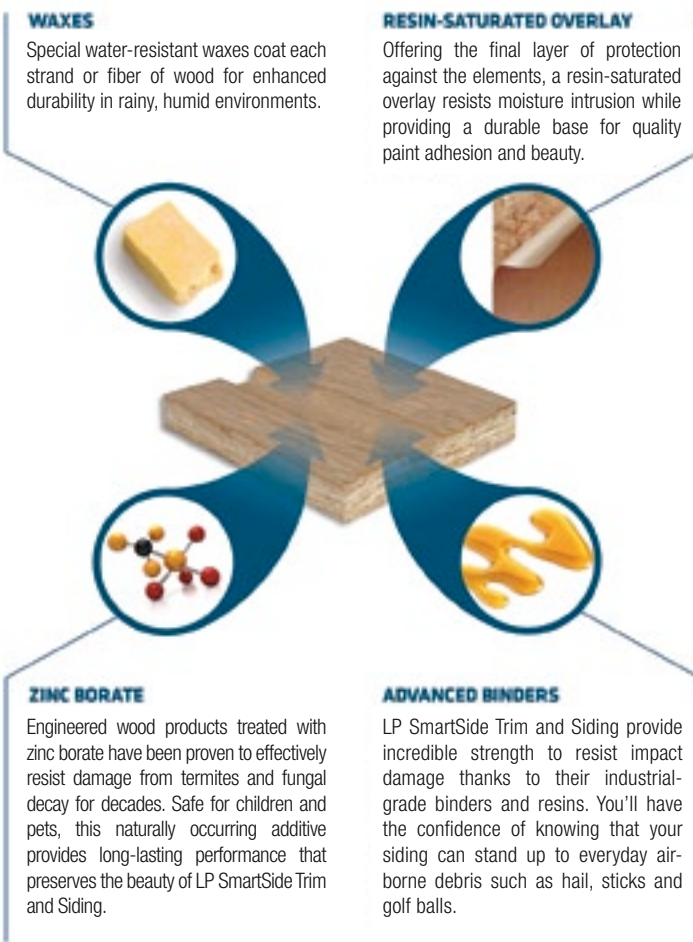

To learn more about LP SmartSide Trim and Siding with SmartGuard, visit: www.lpsmartside.com

FORMOSAN TERMITES

To put LP SmartSide siding products to the ultimate test, LP regularly exposes samples to Formosan termites, widely recognized as one of the world's most destructive pests. Each sample is placed on a plastic grid, surrounded by untreated bait samples, then laid directly on top of termite colonies. Even after 3 years, the LP SmartSide siding shows no structural damage, while the bait samples were completely destroyed within three months.

UNTREATED WOOD vs. LP SMARTSIDE PRODUCT

Untreated wood devastated by Formosan termites (left) and undamaged LP SmartSide product protected with the SmartGuard® process (right) during same testing period.

FORMOSAN TERMITE DISTRIBUTION IN THE US



OPTIONS & UPGRADES



Customize your new shed by adding options or upgrading existing features to better meet your needs!

FOR YOUR BUILDING

Door Options

(All doors are insulated except Roll Up door)



3 ft. Door
\$225



3 ft. Door with 9-Lite Window—\$300



4 ft. Door
\$250



5 ft. Door
\$300



6 ft. Door
\$400



6 ft. Door with 9-Lite Windows
\$550



Roll Up Door
6 x 7—\$450 8 x 7—\$500 9 x 7—\$550

Window Options



Small Window
(2 x 2)—\$80



Large Window
(2 x 3)—\$85



X-Large Window
(3 x 3)—\$100



X-Large Insulated Vinyl Window
(3 x 3)—\$195



Shutters
—\$50 per window
Flower Boxes
—\$40 per window



Radiant Barrier
Thermostat R.B. (Roof)—\$.75 sq. ft.
SilverTech R.B. (Walls)—\$1.50 sq. ft.



Shelves & Workbenches
(2' deep) \$5.50 sq. ft.



Shelf Package \$175

Exterior Paint Colors — Trim & Siding						
White	Tinsmith	Cape Cod Gray	Black	Yoder Blue	Wedgewood Blue	Belmont Blue
Sandstone	Beige	Clay	Quaker Tan	Brown	Harvest Red	Hunter Green

Architectural Shingles available upon request for \$200

Metal Roof Colors			
Polar White	Burnished Slate	Rustic Red	Ivy Green

All color swatches are representational and may not match actual product exactly.

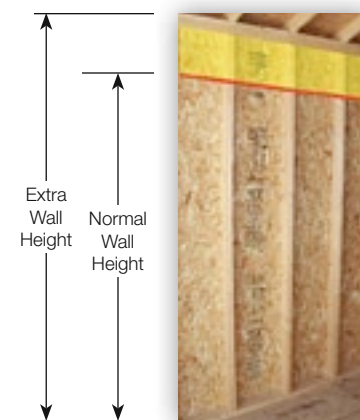

Extra wall height
\$200

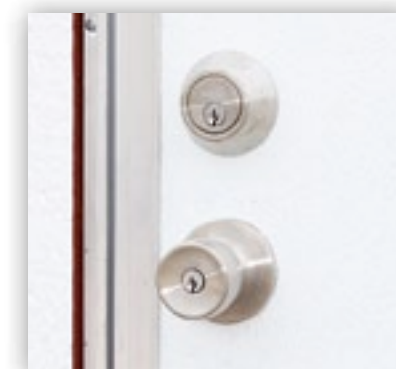

Interested in a more secure building? What are your valuables worth to you? Get a deadbolt-equipped door—only \$85. (Not available in any door with glass).

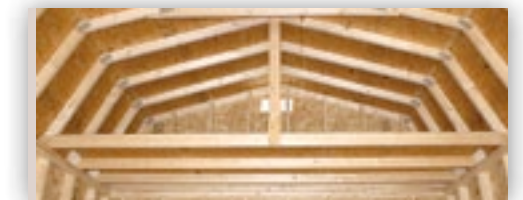

Extra Loft Space \$3.50 sq. ft.



Ramp
4' wide—\$140 5' wide—\$150 6' wide—\$160
8' wide—\$230 9' wide—\$240



Old-Fashioned Quality **Hometown Service** Unbeatable Value



*FREE DELIVERY**
and Setup

For your safety and convenience, our professional driver will deliver and setup your building for you free of charge. Our setup includes the concrete blocks necessary to level your building, which we provide to you for free. When we are finished, your building is level, solid, and ready for you to use!

** Free delivery within 50 miles of your local dealer. Owner is responsible for site preparation and permits if required.*



Free Delivery Area

© 2018 Bald Eagle Barns, LLC; all rights reserved. All information and prices subject to change without notice. 12' & 14' buildings are measured from eave to eave; footprint is narrower.



Authorized Dealer

